

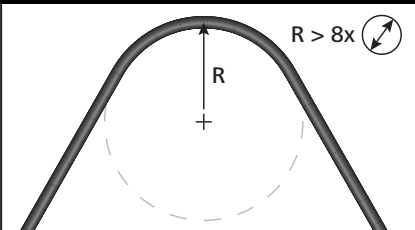

RapidNet Copper

Minimum bend radius during installation



1. Bend radius during installation shall never be less than 8 times the diameter of the cable.

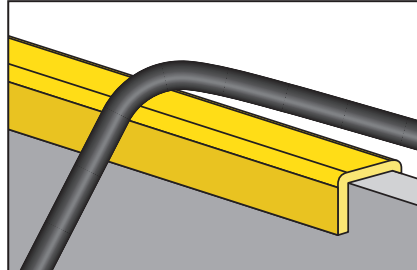

2. Guides/runners/edge protectors shall be used on all corners to protect cables and maintain minimum bend radius.

Minimum bend radius during operation

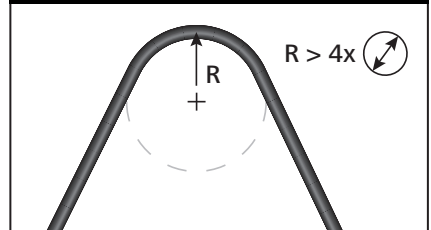

3. Bend Radius during operation shall never be less than 4 times the diameter of the cable.

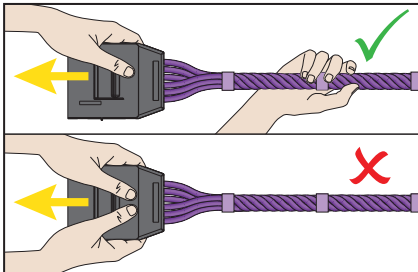

4. Never pull the assembly by holding the cassette. Always pull on the cable whilst supporting the cassette.

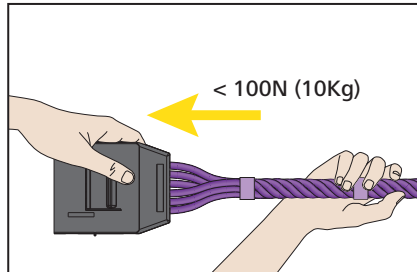

5. Maximum pull force on the cable during installation shall never exceed 100N (10kg).

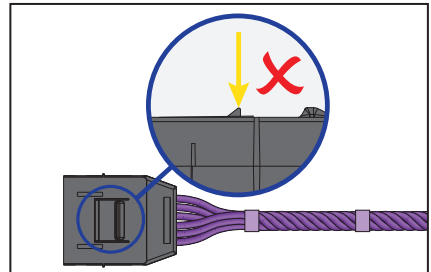

6. Release clips on the cassette must stay in the locked/back position except when used to disengage the cassette from the panel.

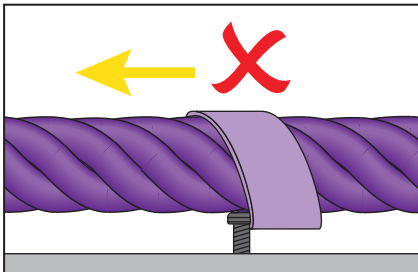

7. Never pull the cable if the wrapping tapes get snagged. Always go back to release before pulling.

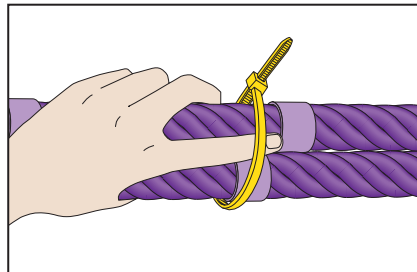

8. Never over tighten cable ties; placing a finger under the tie as it is tightened gives a good indication of the pressure on the cable.

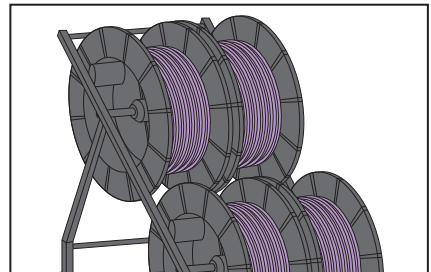

9. For lengths over 25 metres the installation trolley MUST be used to avoid twists of the cable.

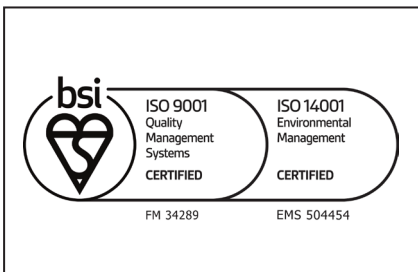

10. The Installation shall comply with all parts of BSEN 50174 standard.



HellermannTyton Data Ltd – UK

Tel: +44 (0) 1604 706633

www.htdata.co.uk