



6

LAN Connectivity Data Outlets

Category 6 Shielded

Keystone Jack

Application/Product Description

Category 6 Shielded outlets are designed to support Ethernet 10BASE-T, 100BASE-T (Fast Ethernet), 1000BASE-T (Gigabit Ethernet), 155 Mb/s ATM, Token Ring 4/16, voice/data systems and Voice over Internet Protocol (VoIP) systems running over a Category 6 cabling system and is backwards compatible with existing Category 5e, Category 5 and voice network infrastructures.

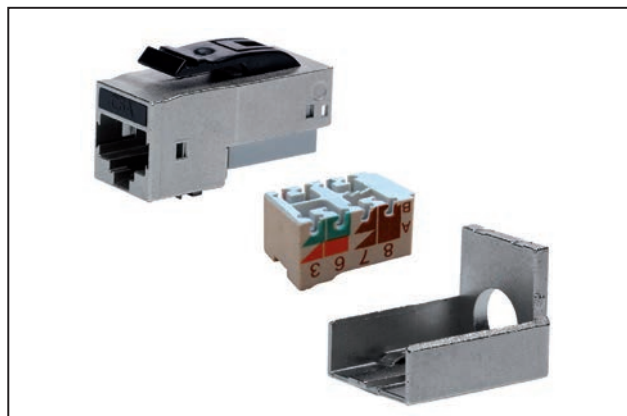

Category 6 Keystone Jack

Technical Data

Specification	Category 6		
Conformance	<ul style="list-style-type: none"> • ISO 11801:2002 (inc. Amend. A1 & A2) • BS EN 50173 • ANSI/TIA/EIA 568-C.2 		
Wiring Specification	568A/B		
Dimensions (mm)	H	W	D
	23.0	16.0	36.0
Weight (g)	26		
Outlet Style	RJ45		
RJ45 Jack Life	Minimum Insertions 1000		
Punch Down Blocks	IDC (No punchdown tool required)		
IDC Life	Minimum 50 re-terminations		
Wire Gauge	22-24 AWG (Maximum of 2 wires per contact).		

Material	
Modular Jack Housing	Nickel
Housing Colour	Mill Finish
Contacts	Phosphor Bronze Nickel Plated with Selective Gold

Performance Characteristics

Frequency (MHz)		1	100	250
Insertion Loss	Spec	3.0	18.0	43.8
	Typical	2.3	17.8	41.5
NEXT (dB)	Spec	65.0	41.8	26.7
	Typical	87.0	53.9	40.4
ACR-N (dB)	Spec	62.0	23.9	-17.1
	Typical	84.7	36.1	-1.3
Return Loss (dB)	Spec	19.1	14.0	8.0
	Typical	27.6	32.7	18.8
PS NEXT (dB)	Spec	62.0	39.3	23.8
	Typical	81.1	48.4	34.1
PS ACR-N (dB)	Spec	59.0	21.3	-20.0
	Typical	78.8	30.6	-7.5
ACR-F (dB)	Spec	64.2	24.2	10.2
	Typical	82.9	49.1	32.1
PS ACR-F (dB)	Spec	61.2	21.2	7.2
	Typical	77.1	42.7	25.8

*Typical values are for permanent link tests when using the complete HellermannTyton Data System.

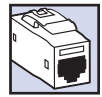

Technical Diagrams

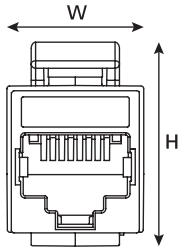

Front view

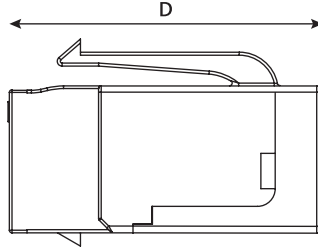

Side view

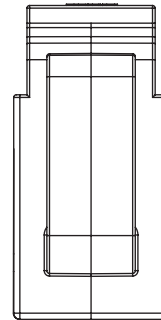

Top view

This document is subject to change without notice.
The current version available from www.htdata.co.uk/site/products/data-outlets