

HellermannTyton

Home Network Sciences

owner's manual

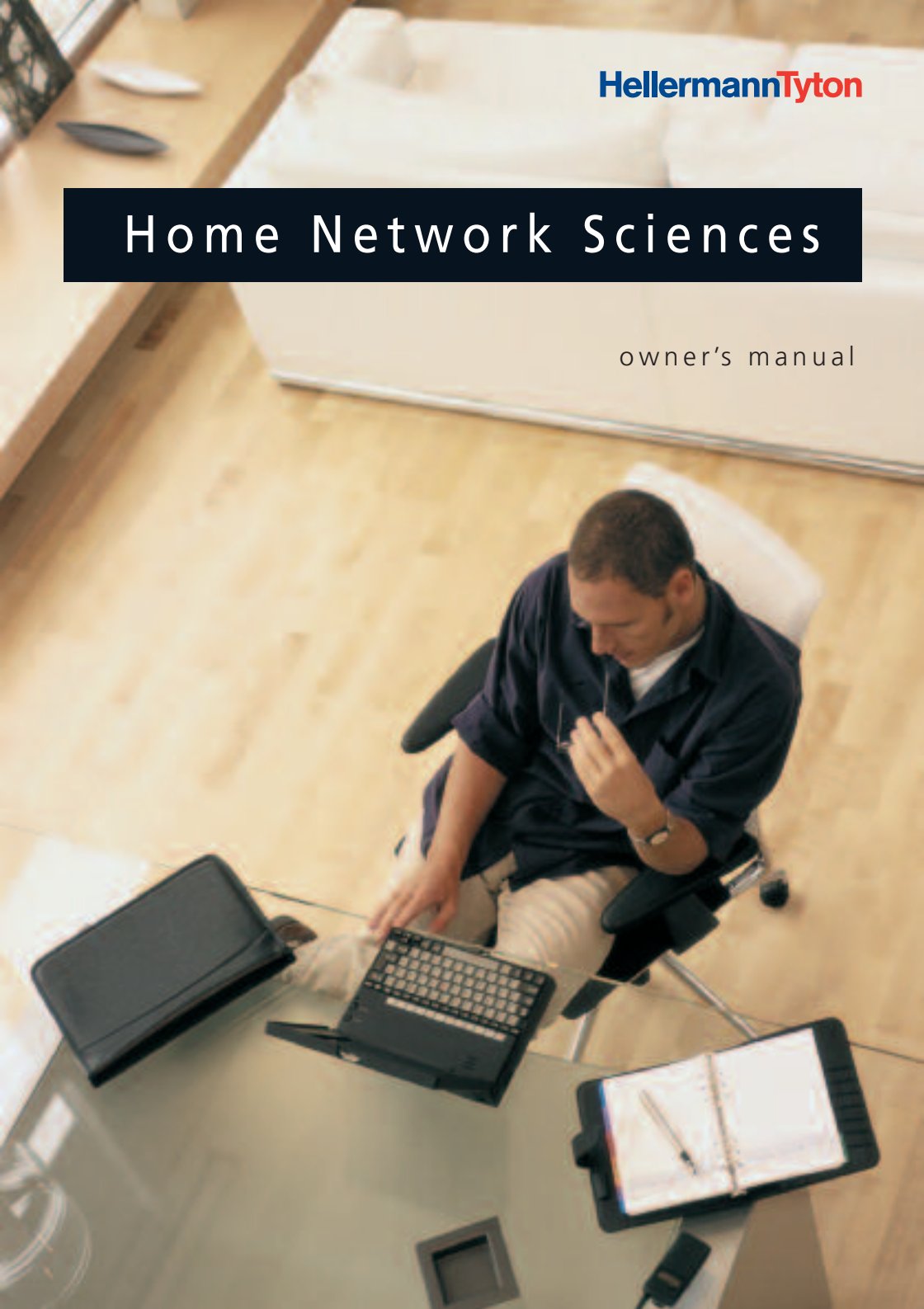

Welcome

Congratulations on choosing a home fitted with the **Home Network Sciences System**.

Depending on the actual specification of the system you can distribute your telephone services, internet connections, television, video, DVD and satellite throughout your home.

The system also has a number of other capabilities which may be included as standard or can be added as options. These include CCTV, multi-room audio and infra-red passing for remote controls.

The system uses industry standard cabling types to carry audio, video and data signals around your home. These cables are used to connect telephone, data and television outlets to a central chassis unit. The chassis acts as distribution panel and may also house active electronic components for the system.

This Owner's Guide is designed to help you get the most from your "Home Network Sciences" system. Don't be afraid to open the chassis cover and use the guide to familiarise yourself with the system components and configure the system to suit your needs. You'll find that using the system will give you maximum flexibility in the way you use telephones, computers and televisions in your home.

For the latest product and technical information please visit our website:
www.homenetworksciences.com

KEY TO SYSTEM DIAGRAM

Central Chassis Unit

- 1 TELEPHONE LINE Module (4 ports per line)
- 2 TELEPHONE OUTLET Module
- 3 Switch or ADSL Router
- 4 DATA OUTLET Module
- 5 CCTV Camera Module
- 6 CCTV Switcher
- 7 CCTV Modulator
- 8 Audio Hub
- 9 TV Distribution Modules
- 10 Patch Leads
- 11 BT Launch Lead

Outlets

- A Voice Outlet
- B Data Outlet
- C Main TV Viewing Point
- D Diplex TV Outlet
- E Single TV Outlet

NOTE: The equipment fitted to your HNS Chassis may differ from that shown.

The System

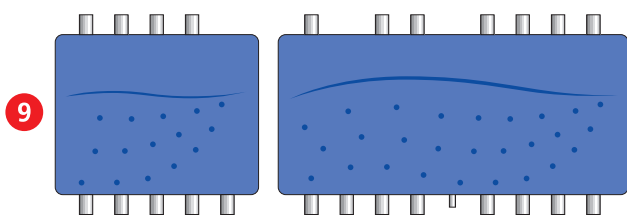
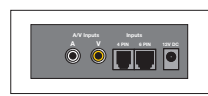
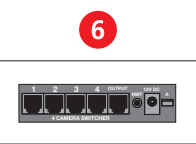
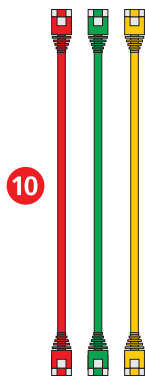
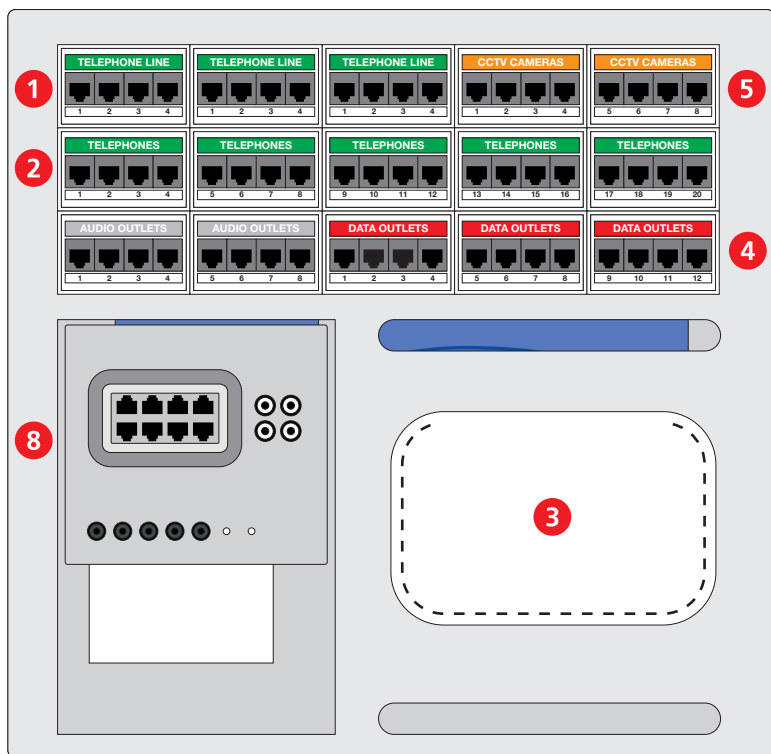

11

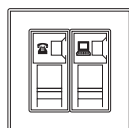

A B

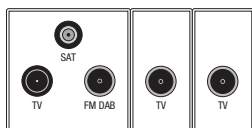

C

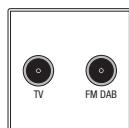

D

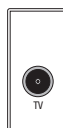

E

Telephone, Modem & Fax

CONNECTING TELEPHONE LINE(S)

- Ensure the cable from the rear of each Telephone Line Module is connected to a telephone master socket.
- Each additional telephone line requires an additional module.
- Each Telephone Line Module can connect up to four pieces of equipment.

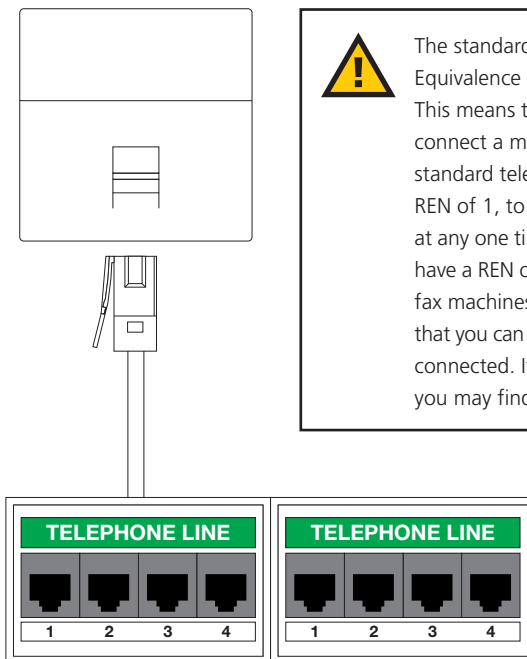

The standard REN = 4 (Ring Equivalence Number) applies here. This means that you may only connect a maximum of four standard telephones, each with a REN of 1, to the telephone system at any one time. Other devices may have a REN of more than 1 (such as fax machines) and this will mean that you can have fewer telephones connected. If you connect more, you may find that they fail to ring.



Your telephone numbers may be inserted under the removable label lenses of the Telephone Line Modules.

CONNECTING TELEPHONES

- Select a Voice Outlet and plug in a telephone (fax machines and computer modems can be connected in the same way).
- Make a note of the "Outlet Number" (in this example it is "2").

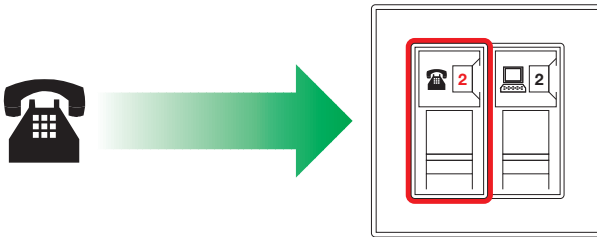

- At the chassis, plug a patch lead into the module labelled "TELEPHONES" using the socket with the same number as that noted from the Outlet.
- Connect the other end of this patch lead to one of the sockets on the Telephone Line Module. If you have more than one line ensure you connect to the correct Telephone Line Module.
- Repeat this procedure for further phones and modems.

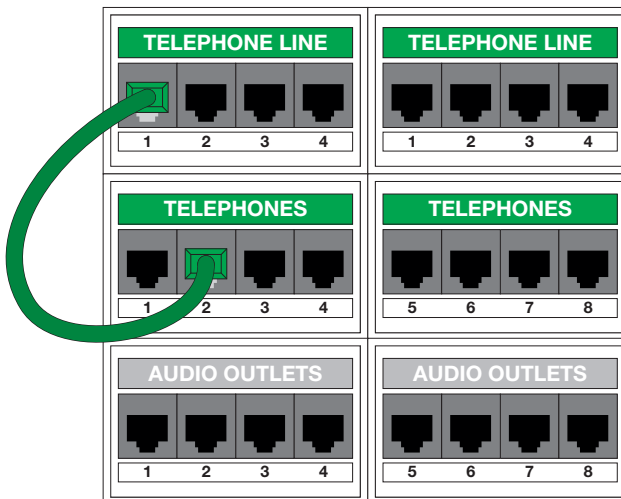

Computers & Networks

DATA NETWORKING

Depending on your system configuration, you will have a number of data sockets available around your home. These can be used to create a Local Area Network or LAN.

A LAN allows computers and other Network Enabled Devices to communicate with each other.

You may also connect your LAN to the Internet to allow all of your Computers access to On-line Services.

The system will need to be fitted with a Hub or Switch to create a LAN and a Modem or Router is required to connect to the Internet. If not fitted as standard, Switch and ADSL Router packages are available as an upgrade. Ask your HNS installer for details.

A software upgrade may be required to enable your networked devices to communicate. Contact your HNS installer for advice.



Your Internet Service Provider (ISP) may not support the connection of multiple computers over one line, and may not provide support if you have a configuration problem.

CREATING A LOCAL AREA NETWORK

- Select one or more Data Outlets and plug in computers or network enabled devices.
- Make a note of the "Outlet Numbers" (in this example they are "2" & "3").

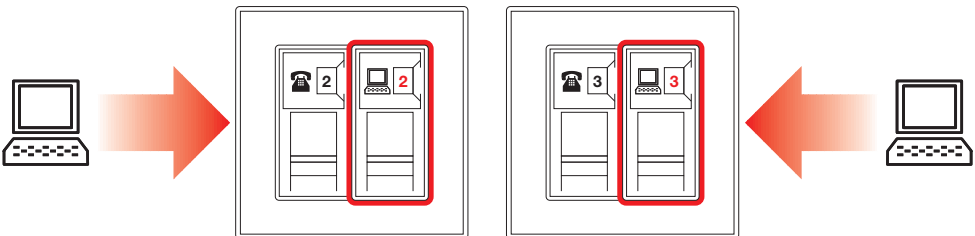

- At the chassis, plug a patch lead into the module labelled "DATA OUTLETS" using a socket with the same number as one of those noted from the Outlet.

CREATING A LOCAL AREA NETWORK (cont.)

- Connect the other end of this lead to one of the sockets on the switch/router mounted in the chassis.
- Repeat this procedure for further computers and network ready devices.

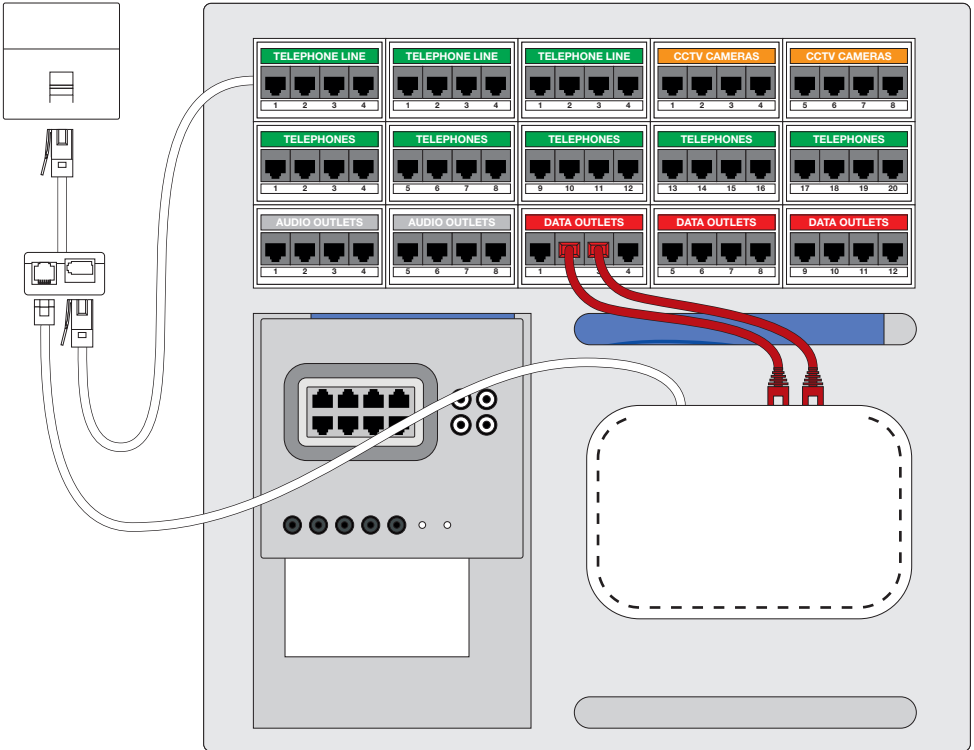

CONNECTING THE LAN TO THE INTERNET

- The ADSL modem/router should be connected to the switch via a short patch lead.
- The modem should be connected to the ADSL line using the line filter supplied.
- A separate booklet describes the configuration of the Modem and Firewall.



If using routers and switches from other manufacturers, please refer to their own instructions. You may also need to obtain connection information from your ISP.

Television

TV DISTRIBUTION

The TV system allows Analogue and Digital terrestrial TV*, Satellite TV°, CCTV, FM and DAB (Digital Audio) signals* to be distributed to the Main TV viewing point and to other rooms around the property.

Video sources such as VCRs and DVDs† situated at the main TV viewing point may also be viewed at the remote locations.

* Depending on local reception.

° Satellite dish and decoder required.

† Most DVD Players will require a Modulator.
Ask your HNS Installer for details.

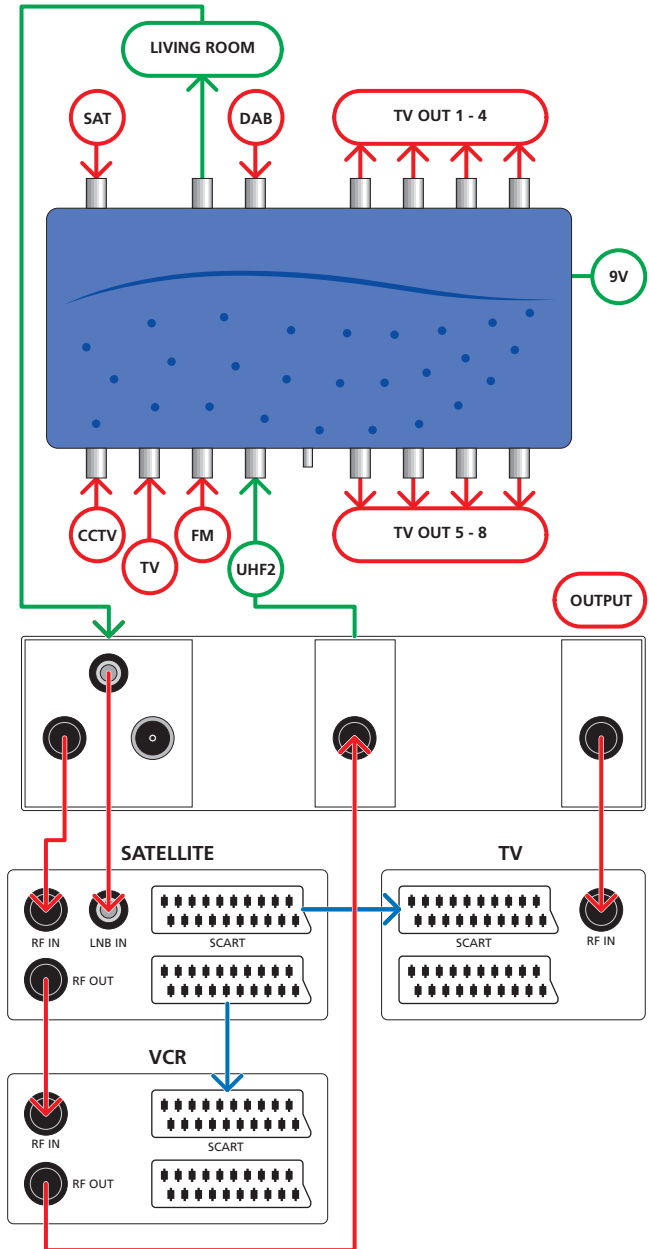

VCR & SATELLITE AT MAIN TV VIEWING POINT

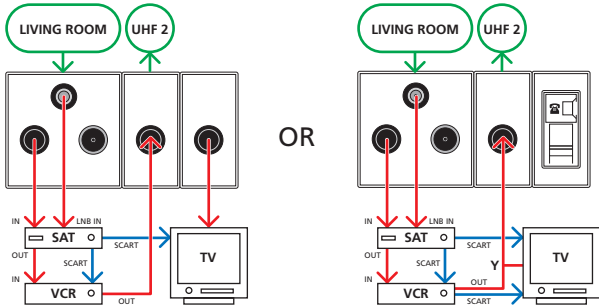

VCR AT MAIN TV VIEWING POINT

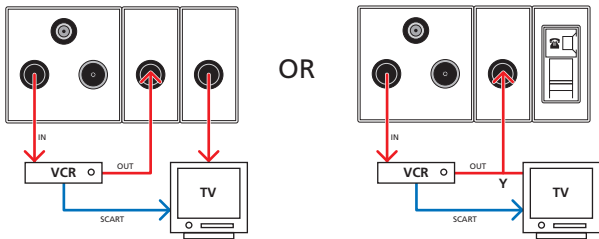

TV AT MAIN TV VIEWING POINT

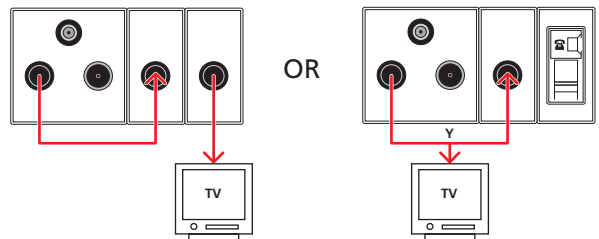

NO EQUIPMENT AT MAIN TV VIEWING POINT

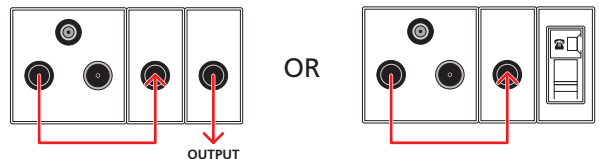

REMOTE LOCATION OUTPUTS

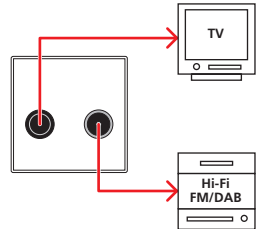

Y CONNECTOR

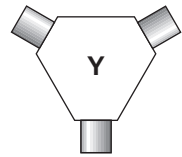

Ensure the TV at the **Main TV Viewing Point** is connected to the TV outlet and **NOT** the FM/DAB outlet.



Make sure a connection is in place between the downlink and uplink at the **Main TV Viewing Point** or no signal will be present in the other rooms.

IR Passing

INFRA-RED PASSING SYSTEM

The infra-red passing system allows you to control central sources such as DVDs and Satellite Decoders from other rooms.

VCR & SATELLITE AT MAIN TV VIEWING POINT

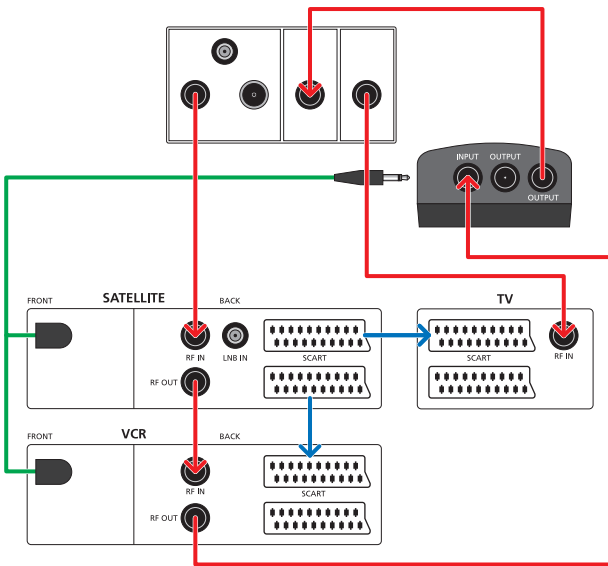

REMOTE LOCATION OUTPUTS

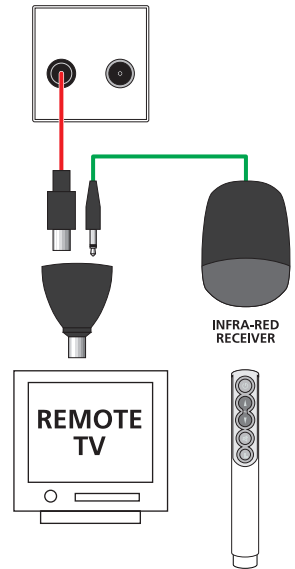

- Ensure the Y connector is attached to the TV at the Remote Location.
- Not all infra-red remote controls are compatible with this system.
- The IR passing system may not be required if the audio system has been installed.

CCTV

CCTV DISTRIBUTION

- TV distribution amp allows for a modulated CCTV input.
- CCTV cameras may already be installed, or cabling for the cameras, or you could use the existing data network.
- The cameras are patched into a 4 way switcher which is then plugged into a modulator.
- The modulator can be set to any TV channel using the DIP switches* on the underside of the modulator. The pictures are now ready to be put into the TV and distributed around the Home.
- The switcher allows 4 cameras to switch between each other or focus on one area and only switch when movement is noticed at the other camera locations.

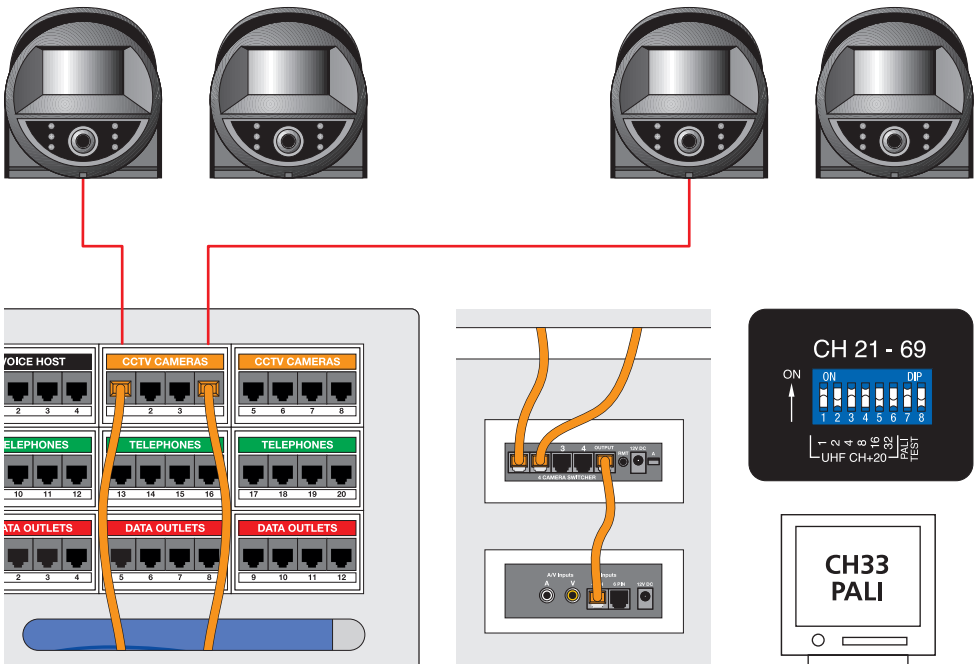

* Changing the output channel may affect other channels. Please contact your installer for assistance.

Audio

AUDIO DISTRIBUTION

- Select a Data Outlet and plug in a Coolport.
- Connect audio leads from the LINE OUT ports on the rear of your Hi-Fi to the Coolport.
- Make a note of the "Outlet Number" (in this example it is "5").



- At the chassis, plug a patch lead into the module labeled "DATA OUTLETS" using the socket with the same number as that noted from the Outlet.
- Connect the other end of this patch lead to the "REMOTE AUDIO IN" socket on the Audio Panel.
- Position the COOLPORT so that the source equipment can receive its infra-red outputs either directly or via window emitters.
- Brief set-up instructions are on the next page. A full instruction manual is included with the audio system.

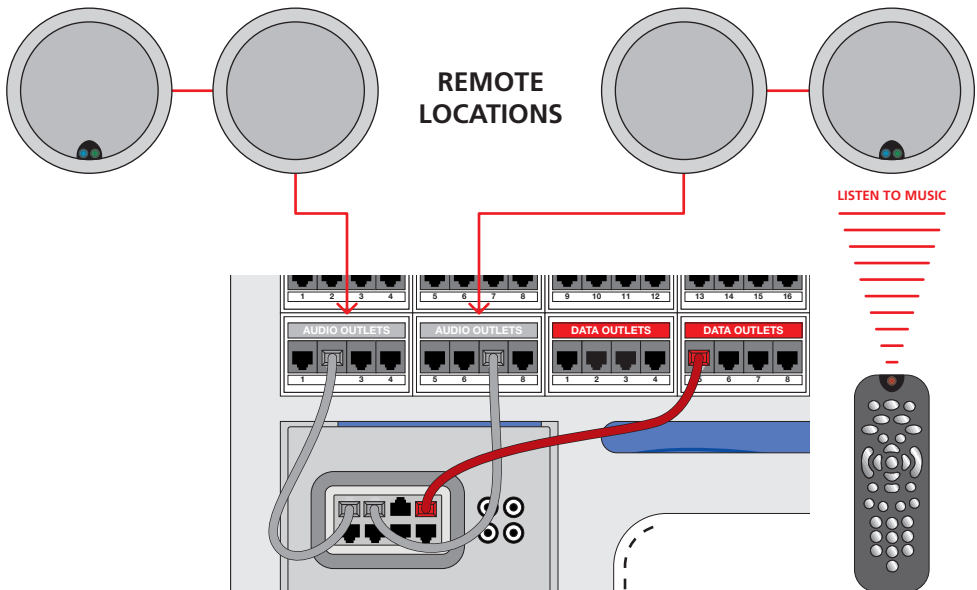

Audio Remote

TO SET BASS, TREBLE, AND VOLUME LEVELS

1. Turn zone on

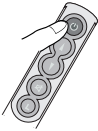
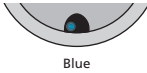

2. Select set-up mode

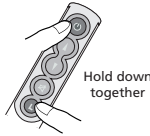

3. Adjust turn-on volume*

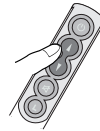

4. Step to next parameter

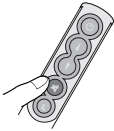
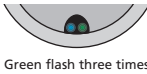

5. Adjust bass*

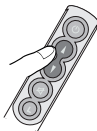

6. Step to next parameter

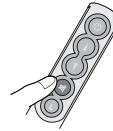
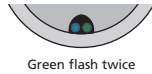

7. Adjust treble*

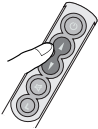

8. Step to next parameter

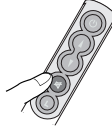
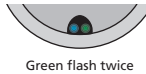

9. Adjust maximum volume*

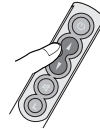

10. Exit from set up

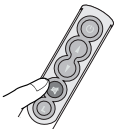

11. Speaker ready for use

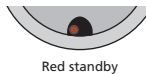

*If a parameter does not need to be changed, press  to skip to next parameter.

Locations

TV OUTLETS	AUDIO OUTLETS	DATA OUTLETS	TELEPHONES	TELEPHONE LINE
1	1	1	1	STD CODE: NUMBER:
2	2	2	2	
3	3	3	3	
4	4	4	4	
TV OUTLETS	AUDIO OUTLETS	DATA OUTLETS	TELEPHONES	TELEPHONE LINE
5	5	5	5	STD CODE: NUMBER:
6	6	6	6	
7	7	7	7	
8	8	8	8	
TV OUTLETS	AUDIO OUTLETS	DATA OUTLETS	TELEPHONES	TELEPHONE LINE
9	9	9	9	STD CODE: NUMBER:
10	10	10	10	
11	11	11	11	
12	12	12	12	
TV OUTLETS	CCTV CAMERAS	DATA OUTLETS	TELEPHONES	TELEPHONE LINE
13	1	13	13	STD CODE: NUMBER:
14	2	14	14	
15	3	15	15	
16	4	16	16	
TV OUTLETS	CCTV CAMERAS	DATA OUTLETS	TELEPHONES	TELEPHONE LINE
17	5	17	17	STD CODE: NUMBER:
18	6	18	18	
19	7	19	19	
20	8	20	20	

Site Installation

CHASSIS REGISTRATION NUMBER:

ADDRESS:

DESCRIPTION

CHASSIS CODE:

TV AMPLIFIER:

PATCH LEADS:

TELECOMS LAUNCH LEAD:

EXTRAS - QUANTITY

DATA OUTLETS:

VOICE OUTLETS:

TV OUTLETS - SINGLE:

TV OUTLETS - DIPLEX:

TV OUTLETS - TRIPLEX:

FACEPLATES SINGLE:

FACEPLATES DOUBLE:

HALF BLANKS:

NON-STANDARD PRODUCTS - DESCRIPTION & QUANTITY

SWITCHES/ROUTERS:

CCTV EQUIPMENT:

AUDIO EQUIPMENT:

OTHER:

SYSTEM - PORT TO PORT TESTED & CORRECT: YES / NO

ADDITIONAL INFORMATION:

DATE:

TEST RESULTS: PASS / FAIL

TEST PERFORMED BY:



It is recommended that an approved HNS Installer carries out any servicing or modification to your system. Servicing or modification by unauthorised personnel may invalidate the warranty.

Approved Installer

Home Network Sciences

a smarter way to live...

Home Network Sciences

Cornwell Business Park, Salthouse Road, Brackmills, Northampton, NN4 7EX

www.homenetworksciences.com