

GigaDuct Fibre Raceway

The future of data centre cable management starts with our state-of-the-art fibre raceway system. In the dynamic world of data communication, ensuring the optimal performance and protection of your optical fibre cables is paramount.

HellermannTyton's GigaDuct is the ultimate solution designed to revolutionise how you manage and safeguard your critical infrastructure.

Highlights

Variety of
SIZES

FAST
Installation

RIGID

REUSE

UL94/V0

LSZH

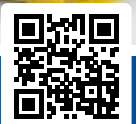
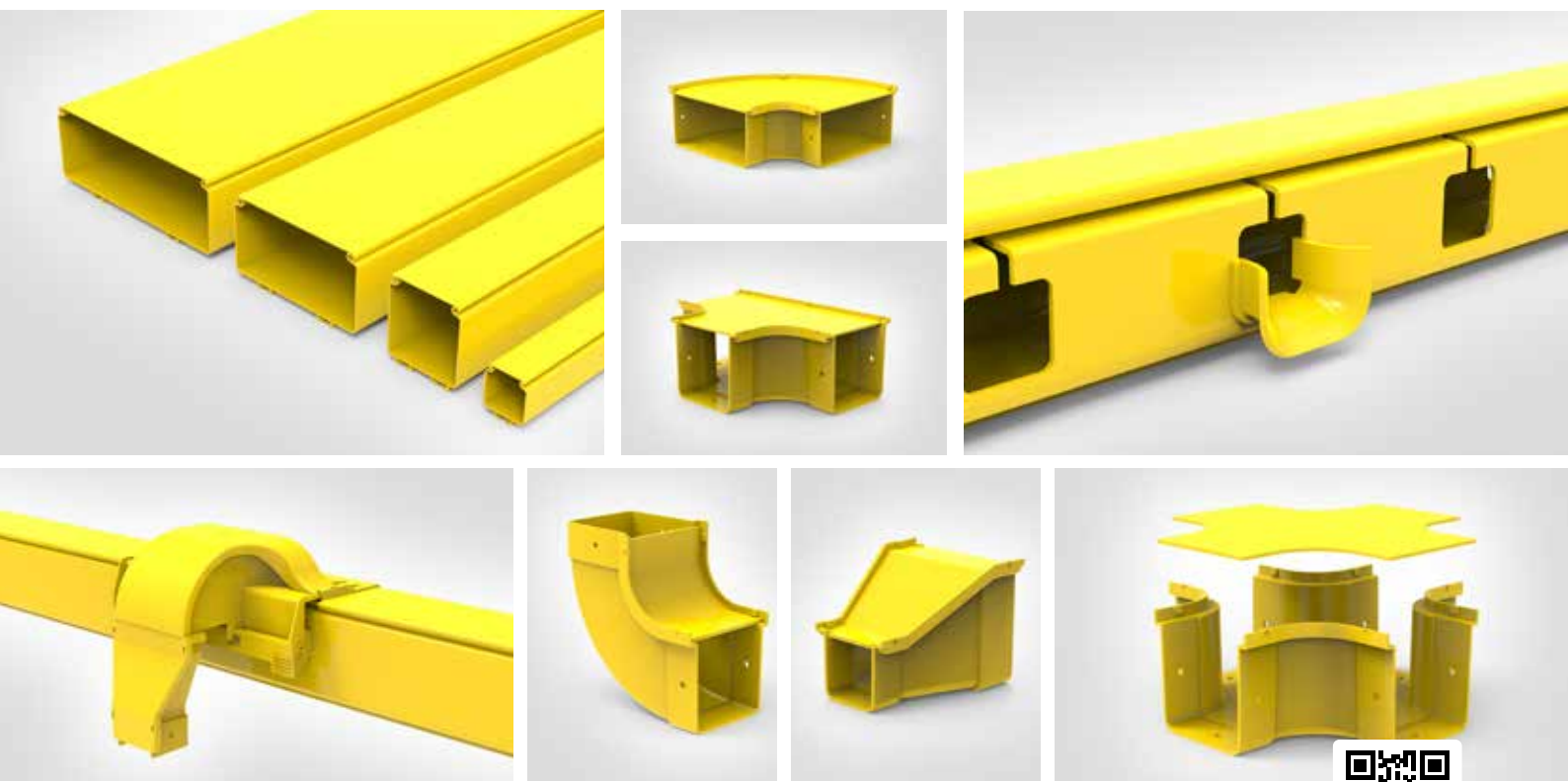

Effortless Setup

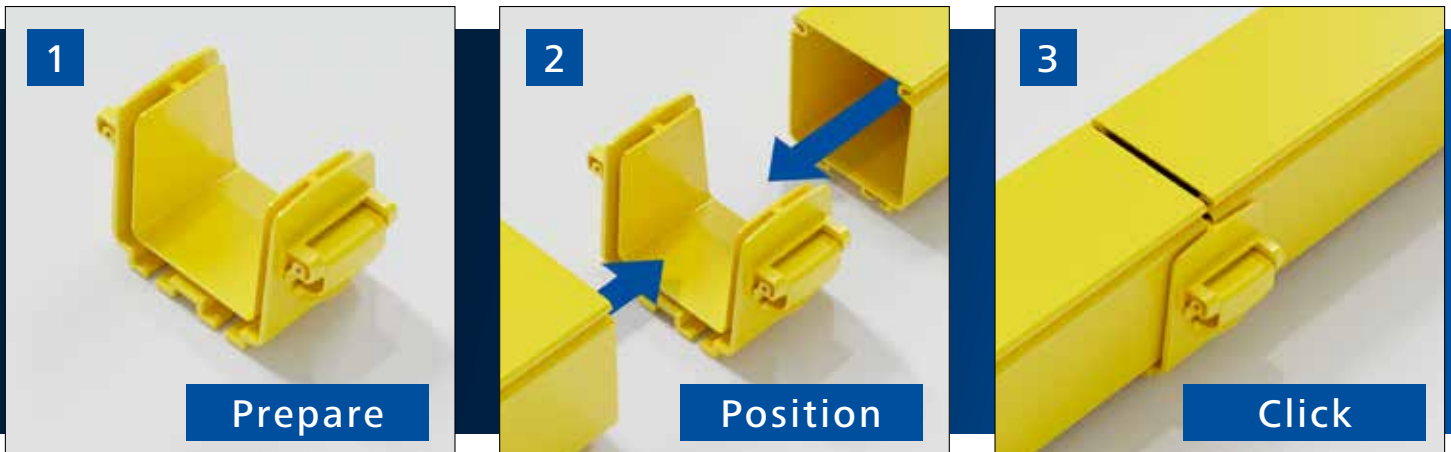

The new tool-free coupler is a key component of HellermannTyton's GigaDuct System. Its defining feature is the ability to connect sections of ducting and fittings without the need for any tools, significantly streamlining installation.

Simply prepare the raceway sections, position the coupler, and connect the sections until you hear a secure click. Need to reconfigure? Just disengage the tabs - no tools required.

Express Waterfall Outlet

An innovative solution designed to manage the critical transition of fibre optic cables, that can be fitted as part of new installations, or to existing systems at any point in the future.

Key features and benefits:

- Protects optical fibre
- Flexible and adaptable
- Tool-free installation
- Optimal cable management
- Safe and compliant

